



Blaze® Grill Skins Owner's Manual



⚠ ATTENTION

INSTALLER: PLEASE LEAVE THESE INSTRUCTIONS WITH THE CONSUMER.

CONSUMER: PLEASE READ & RETAIN THESE INSTRUCTIONS FOR FUTURE REFERENCE AND BEFORE INSTALLING OR OPERATING.

⚠ WARNING

Observe all local codes and ordinances when installing this appliance. If no local codes are applicable, wire unit in accordance with the latest National Electrical Code, ANSI/NFPA 70, or the Canadian Electrical Code, CSA C22.1, whichever is applicable.

- CONTACT INFORMATION -

**Blaze Outdoor Products: 6620 Greenwell Springs Rd, Baton Rouge,
LA 70805**

USA Phone: 866-976-9510

CustomerService@BlazeGrills.com

BLAZEGRILLS.COM



CALIFORNIA PROPOSITION 65 WARNING

WARNING: This product can expose you to chemicals including Chromium (hexavalent compounds), which are known to the State of California to cause cancer and birth defects or other reproductive harm. For more information, go to: www.P65Warnings.ca.gov

This manual applies to the following model numbers:

BLZ-3BSK-RG, BLZ-4BSK-RG, BLZ-5BSK-RG, BLZ-3PROSK-RG, BLZ-4PROSK-RG
BLZ-3BSK-BLK, BLZ-4BSK-BLK, BLZ-5BSK-BLK, BLZ-3PROSK-BLK, BLZ-4PROSK-BLK
BLZ-3BSK-SS, BLZ-4BSK-SS, BLZ-5BSK-SS, BLZ-3PROSK-SS, BLZ-4PROSK-SS

WARNING

- If the information in this manual is not followed exactly, a fire or explosion may result, causing property damage, personal injury, or loss of life.

WARNING

- THE METAL EDGE OF THE GRILL SKIN IS EXTREMELY SHARP ON THE EDGES. IT SHOULD BE HANDLED WITH EXTREME CARE AND WHILE WEARING THICK LEATHER GLOVES.
- This manual should be retained for your information.

WARNING

RISK OF FIRE! THE POWER CORD MUST NOT BE PINCHED AGAINST A SHARP EDGE. SECURE CORD TO AVOID TRIPPING OR SNAGGING. TO REDUCE THE RISK OF FIRE, ELECTRIC SHOCK, OR PERSONAL INJURY, DO NOT RUN CORD UNDER CARPETING. DO NOT COVER CORD WITH THROW RUGS, RUNNERS OR THE LIKE. ARRANGE CORD AWAY FROM TRAFFIC AREAS AND WHERE IT WILL NOT BE TRIPPED OVER.

RISK OF FIRE! TO PREVENT A POSSIBLE FIRE, DO NOT BLOCK AIR INTAKE OR EXHAUST IN ANY MANNER. DO NOT USE ON SOFT SURFACES WHERE OPENINGS MAY BECOME BLOCKED.

RISK OF FIRE! DO NOT BLOW OR PLACE INSULATION AGAINST THE APPLIANCE.

THIS ELECTRIC APPLIANCE IS TESTED AND LISTED FOR USE ONLY WITH THE APPROVED OPTIONAL ACCESSORIES. USE OF OPTIONAL ACCESSORIES NOT SPECIFICALLY TESTED FOR THIS ELECTRIC APPLIANCE COULD VOID THE WARRANTY AND/OR RESULT IN A SAFETY HAZARD.

IF THE INFORMATION IN THESE INSTRUCTIONS IS NOT FOLLOWED EXACTLY, A FIRE OR EXPLOSION MAY RESULT CAUSING PROPERTY DAMAGE, PERSONAL INJURY, OR DEATH. DO NOT STORE OR USE GASOLINE OR OTHER FLAMMABLE VAPORS IN THE VICINITY OF THIS OR ANY OTHER APPLIANCE.

THIS APPLIANCE IS HEAVY. IT IS HIGHLY RECOMMENDED THAT TWO PEOPLE INSTALL THIS APPLIANCE.

DO NOT RUN THE POWER CORD HORIZONTALLY, DIRECTLY BELOW THE APPLIANCE.

Table of Contents

Installation and Assembly	4-7
Care and Cleaning	8
Warranty Information	9
Product Registration	10

Installation

Please allow the grill to cool before you begin the installation of your grill skin.

GRILL SKIN INSTALLATION INSTRUCTIONS:

1. Turn off gas/remove gas lines before moving grill. Pull the grill out of the island or grill cart to gain access to back of grill and place on a level, sturdy surface. If unable to lift appliance and cannot gain access to the back of grill, remove hood following **Figures A and B**.

Be sure to recheck your gas fittings with a soapy solution when you reinstall.

2. Open the hood as shown in **Figure C**.

3. **Figure D:** Remove the temperature gauge and temperature back cover plate by unscrewing the two screws holding the cover on, next remove the two nuts holding the thermometer in place. (Recommended: It is best to use a magnetic socket wrench to ensure the nuts do not fall into the grill hood.)

4. **Figure E:** Remove the hood handle by unscrewing the two screws on the interior of the grill hood. (Recommended: It is best to use a magnetic screwdriver to remove screws from handle to ensure nuts do not fall into the grill hood.)

5. Assemble the stainless steel cover over the existing hood as shown in **Figure F**. Handle the cover with thick, heavy gloves as the edges may be sharp. The cover will fit very snugly against the exterior of the hood.

Figure A

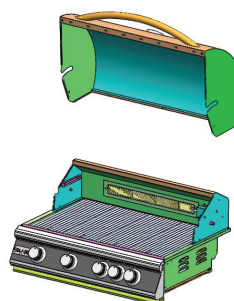


Figure B

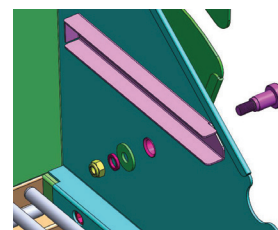


Figure C

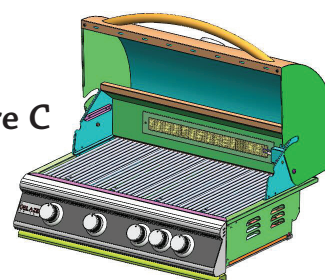


Figure D

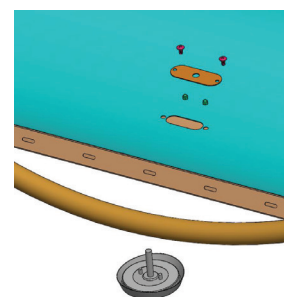


Figure E

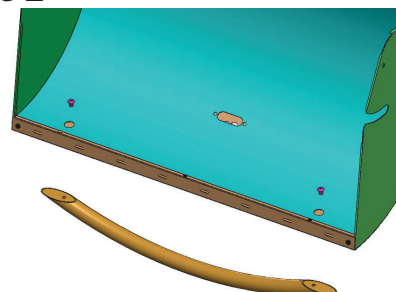
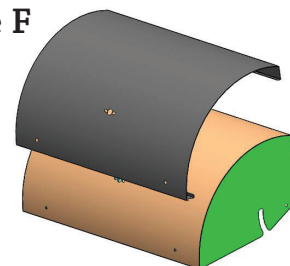


Figure F



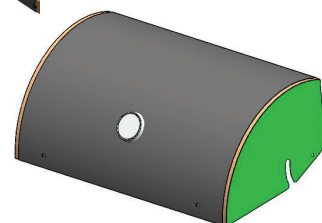
Please allow grill to cool before you begin the installation of your grill skin.

6. Re-insert the temperature gauge in the hood and secure it with two screws, back cover plate, and nuts as shown in **Figures G & H**. (Recommended: It is best to use a magnetic socket wrench to ensure the nuts do not fall into the grill hood.)

Figure G

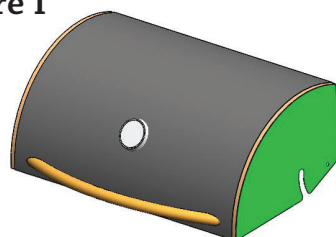


Figure H



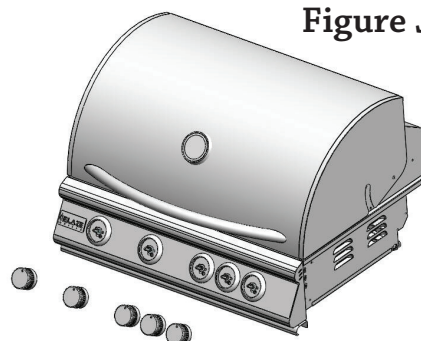
7. Assemble the hood handle by screwing the two screws on the interior of the hood. **Figure I**. (Recommended: It is best to use a magnetic screw driver when removing the screws from handle to ensure nuts do not fall into the grill hood.)

Figure I



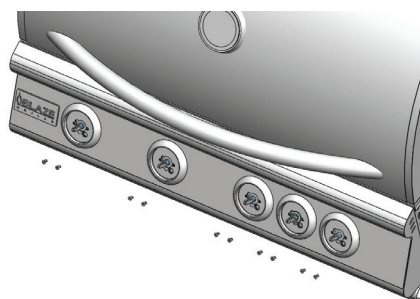
8. Remove the knobs from the control panel by pulling away from the face of the grill as shown in **Figure J**.

Figure J



9. Remove the two screws holding each bezel in place on the control panel as shown in **Figure K**.

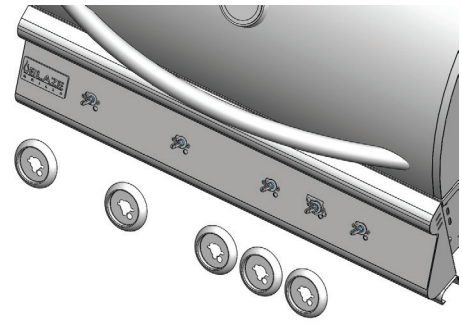
Figure K



Please allow grill to cool before you begin the installation of your grill skin.

10. Remove all bezels from the control panel. **Figure L.**

Figure L



11. Remove the two screws on each side of the grill to remove the control panel and gas manifold. **Figures M & N.**

Figure M

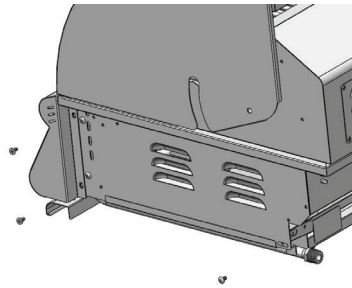
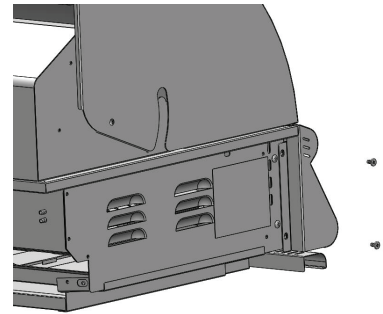
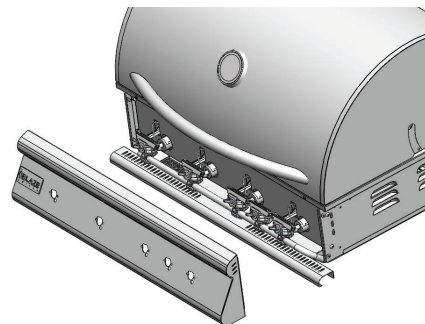


Figure N



12. Remove the control panel from the grill as shown in **Figure O.**

Figure O



13. Unscrew the nuts to remove the Blaze logo badge from the control panel as shown in **Figures P & Q.**

Figure P

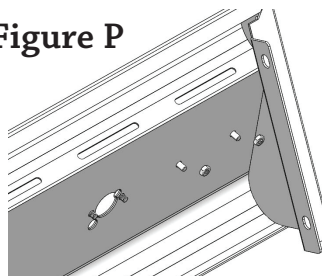
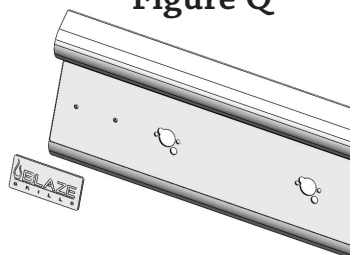


Figure Q



Please allow grill to cool before you begin the installation of your grill skin.

14. Place the control panel cover in place over the control panel as shown in **Figure R**.

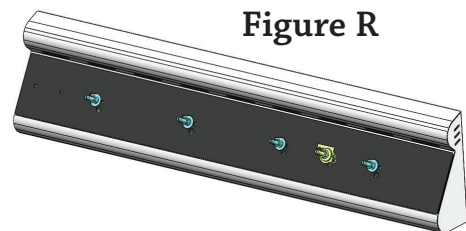


Figure R

15. Assemble the knob bezels with two screws holding the bezel in place on the control panel as shown in **Figure S**. When reinstalling the panel, make sure no wiring is pinched before replacing the control panel.

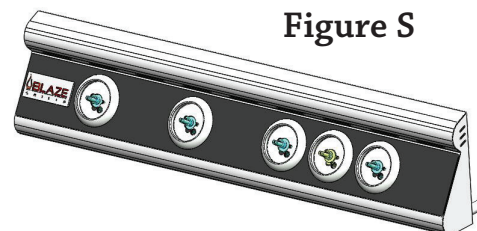


Figure S

16. Put the knobs on the control panel as shown in **Figure T**.

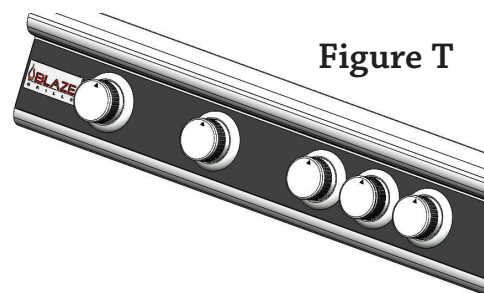
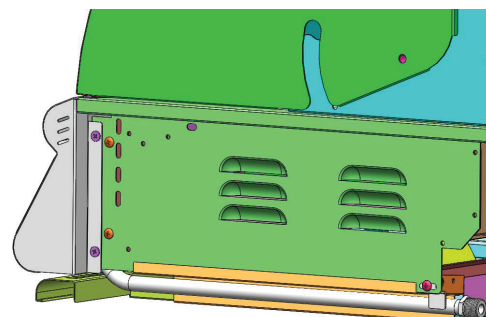


Figure T

17. Re-assemble each side of the control panel and gas manifold as shown in **Figure U**.

Figure U



18. Reconnect the gas line after re-installing your grill. Recheck your gas fittings using a soapy solution.



Care and Cleaning

Your Grill Skin is made from high-quality 304 stainless steel and engineered for durability. Simple care and cleaning will provide a lifetime of service. Refer to your Grill user manual for cleaning guidelines

NOTE: Always wait until your appliance is completely cool before cleaning. Do not clean this product with a water spray or the like.

You should clean your appliance after each use to maintain the overall appearance over the life of your appliance. After the first use, it is normal for your appliance to become discolored in certain areas from the heat produced by the gas burners.

Exterior Cleaning

When cleaning your appliance, always scrub and polish in the direction of the stainless steel grain. Wipe down the exterior of the appliance to remove any splatter or grease. Do not use harsh abrasives. Use a stainless steel cleaner to clean the exterior surface for a polished look. Before installing the vinyl cover, always allow the surface to dry. DO NOT cover a damp appliance.

Warranty Registration

If you have purchased a Blaze Product, you must register your product within 30 days of purchase to validate the warranty and maintain your original receipt to get parts for the appliance. You may register your appliance at www.blazegrills.com by selecting Support, and then selecting Register your Product. The warranty is for original owners only at the original site of delivery and cannot be transferred to new owners. You must retain your sales slip or invoice for warranty to apply.

Installation, repair, and maintenance work should be performed by an authorized service technician. Work by unqualified persons could be dangerous and will void the warranty. All appliances must have a qualified installer complete the installation for the warranty to be in effect. Incorrect installation of the Blaze appliance will void the warranty. Please call Blaze Outdoor Products for more information on correct installation of the appliance.

Blaze Outdoor Products shall not be liable under this or any implied warranty for incidental or consequential damages, and Blaze Outdoor Products' liability is limited to the purchase price of the appliance only. This warranty gives you specific legal rights, and you may also have other rights, which may vary from state to state. This warranty is applicable in the United States and Canada only.

Improper maintenance, high cooking temperatures, excessive humidity, chlorine, fertilizers, lawn pesticides, chemicals, and salt can affect the stainless steel components, and for these reasons, the warranties DO NOT COVER DISCOLORATION, SURFACE RUST, OR RUST, unless there is a loss of structural integrity/rust through of the appliance components. This warranty covers defects in material and workmanship.

WARRANTY ON PARTS:

Grill Skins – 3 Years (Parts Only)

Consumers are responsible for all shipping costs associated with warranty parts and labor costs. All warranty claims are subject to manufacturer review. Please make sure to have your sales receipt information and product serial number located on the outside left side panel of the appliance. All replacement parts can be purchased through your local stocking dealer.

ATTENTION INTERNATIONAL CUSTOMERS: Please consult your selling dealer or distributor for specifics pertaining to your product warranty and procedure. No one other than the selling dealer or distributor is authorized to perform any obligations under this warranty.

Blaze Product Registration

Please take a minute to let us know what you bought. This ensures we keep you up to date and have your info ready if you ever need warranty help! You may register your product electronically on the Blaze website blazegrills.com.

Name

First _____ Last _____

Email _____

Phone _____

Street Address _____

Street Address Line 2 _____

City _____ State/Province/Region _____

Zip/Postal Code _____ Country _____

What is the model number of the Blaze product purchased?

What size Blaze product did you purchase?

Where did you buy your Blaze product?
